

PERFORMANCE:

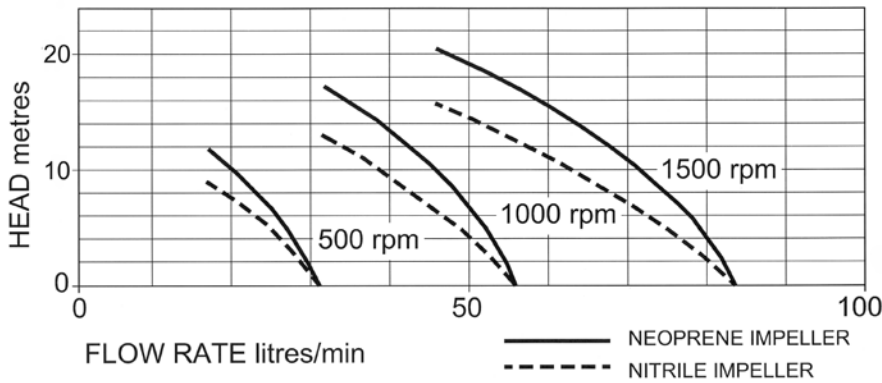

MODEL	Maximum flow rate		Maximum head	
	l/min	gall/min	metres	feet
52580-2001	82	18	20	65
52580-2003	82	18	18	59

Max Power absorbed 550 watt at 1500rpm

DIMENSIONS:

WEIGHT: 3.33Kg

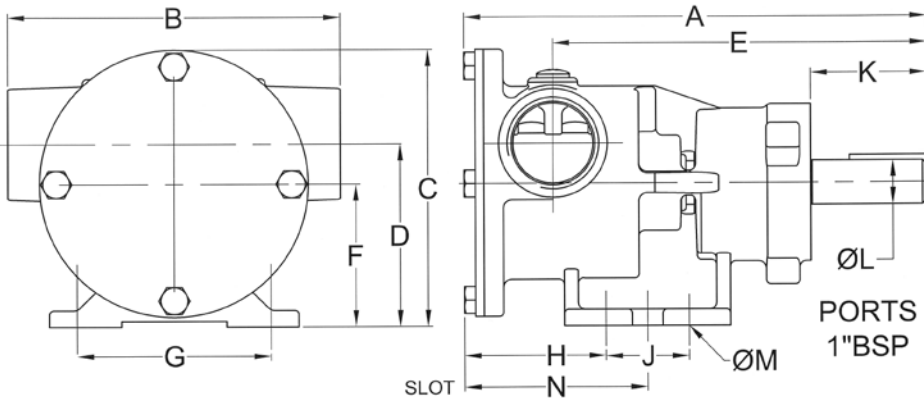

A	B	C	D	E	F	G	H	J	K	ØL	M	N
167	120	101	67	135	52	70	51	30	42	Ø16	Ø9	66

MATERIALS OF CONSTRUCTION:

Body	Bronze
Impeller	Neoprene or Nitrile
Wearplate	Replaceable
Shaft	Stainless steel type 316
Shaft seal	Mechanical, carbon/ceramic
Bearings	Twin row, ball type
Port type	1" BSP to BS21 (DIN2999)

MODELS:

52580-2001 Standard Neoprene Impeller

52580-2003 Oil resistant Nitrile

52580-2021 High pressure Neoprene



a xylem brand

BRONZE FLEXIBLE IMPELLER PEDESTAL PUMP

52580 SERIES



PUMP with 1" BSP PORTS

- * Constructed from marine quality bronze and stainless steel
- * Self-prime from dry up to 2.4m
- * Easy to service and maintain
- * Will tolerate abrasive wear
- * Handles hard and soft solids without clogging
- * Can pump in either direction
- * Will not airlock